

YE3系列三相异步电动机

YE3 series three-phase induction motors

YE3系列为全新设计的超高效低压三相异步电动机，采用高强度铸铁结构，具有效率高、可靠性高、造型美观、噪音低、振动小等特点，适用于风机、水泵、压缩机及工程机械等需要节能并连续运行的工业领域。

The YE3 series of ultra high efficiency three phase asynchronous motors with high strength cast iron structure, have the characteristics of ultra high efficiency, beautiful appearance, low noise, little vibration, and can be applied to fan, pump, compressor, construction machinery and other machines that need energy-saving and continuous operation.



产品使用条件 WORKING CONDITION

额定功率: 0.75~375kw	Rate power : 0.75~375kw
机座号: 80~355	Frame size : 80~355
极数: 2极、4极、6极	Poles : 2p、4p、6p
防护等级: IP55	Protection degree : IP55
绝缘等级: F	Insulation class : F
冷却方式: IC411	Cooling method : IC411
工作制: S1 连续工作制	Duty : S1 Continuous working system
能效等级: GB18613-2020 3级	Efficiency class : GB18613-2020 grade3
(享受国家惠民产品补贴)	(State subsidies)

产品技术数据 SPECIFICATION

型号 Type	功率 Output (KW)	电流 Amps (A)	转速 Speed r/min	效率 Eff. (%)	功率因数 Power Factor	堵转转矩 额定转矩 Locked Rotor Torque Rated Torque	最大转矩 额定转矩 Breakdown Torque Rated Torque	堵转电流 额定电流 Locked Rotor Current Rated Current	重量 Weight (kg)
YE3-80M1-2	0.75	1.7	2865	80.7	0.82	2.3	2.3	7.0	16
YE3-80M2-2	1.1	2.4	2880	82.7	0.83	2.2	2.3	7.3	19
YE3-80M-4	0.75	1.8	1435	82.5	0.75	2.3	2.3	6.6	19
YE3-90S-2	1.5	3.2	2990	84.2	0.84	2.2	2.3	7.6	25
YE3-90L-2	2.2	4.6	2990	85.9	0.85	2.2	2.3	7.6	30
YE3-90S-4	1.1	2.6	1435	84.1	0.76	2.3	2.3	6.8	26
YE3-90L-4	1.5	3.5	1440	85.3	0.77	2.3	2.3	7.0	31
YE3-90S-6	0.75	2.0	950	78.9	0.71	2.0	2.1	6.0	26
YE3-90L-6	1.1	2.8	950	81.0	0.73	2.0	2.1	6.0	32
YE3-100L-2	3	6.0	2900	87.1	0.87	2.2	2.3	7.8	40
YE3-100L1-4	2.2	4.8	1450	86.7	0.81	2.3	2.3	7.6	42
YE3-100L2-4	3	6.3	1450	87.7	0.82	2.3	2.3	7.6	46
YE3-100L-6	1.5	3.8	950	82.5	0.73	2.0	2.1	6.5	44
YE3-112M-2	4	7.8	2910	88.1	0.88	2.2	2.3	8.3	48
YE3-112M-4	4	8.4	1455	88.6	0.82	2.2	2.3	7.8	55

产品技术数据 SPECIFICATION

型号 Type	功率 Output (KW)	电流 Amps (A)	转速 Speed r/min	效率 Eff. (%)	功率因数 Power Factor	堵转转矩 额定转矩 Locked Rotor Torque Rated Torque	最大转矩 额定转矩 Breakdown Torque Rated Torque	堵转电流 额定电流 Locked Rotor Current Rated Current	重量 Weight (kg)
YE3-112M-6	2.2	5.4	955	84.3	0.74	2.0	2.1	6.6	48
YE3-132S1-2	5.5	10.6	2920	89.2	0.88	2.0	2.3	8.3	64
YE3-132S2-2	7.5	14.4	2920	90.1	0.88	2.0	2.3	7.8	70
YE3-132S-4	5.5	11.2	1460	89.6	0.83	2.0	2.3	7.5	69
YE3-132M-4	7.5	15.0	1460	90.4	0.84	2.0	2.3	7.9	83
YE3-132S-6	3	7.2	970	85.6	0.74	2.0	2.1	6.8	59
YE3-132M1-6	4	9.5	970	86.8	0.74	2.0	2.1	6.8	71
YE3-132M2-6	5.5	12.7	970	88.0	0.75	2.0	2.1	7.0	73
YE3-160M1-2	11	20.6	2942	91.2	0.89	2.0	2.3	8.1	125
YE3-160M2-2	15	27.9	2942	91.9	0.89	2.0	2.3	8.1	144
YE3-160L-2	18.5	34.2	2942	92.4	0.89	2.0	2.3	8.2	155
YE3-160M-4	11	21.5	1470	91.4	0.85	2.2	2.3	7.7	124
YE3-160L-4	15	28.8	1470	92.1	0.86	2.2	2.3	7.8	144
YE3-160M-6	7.5	16.2	976	89.1	0.79	2.0	2.1	7.0	115
YE3-160L-6	11	23.1	976	90.3	0.80	2.0	2.1	7.2	135
YE3-180M-2	22	40.5	2960	92.7	0.89	2.0	2.3	8.2	205
YE3-180M-4	18.5	35.3	1475	92.6	0.86	2.0	2.3	7.8	186
YE3-180L-4	22	41.8	1475	93.0	0.86	2.0	2.3	7.8	223
YE3-180L-6	15	30.9	980	91.2	0.81	2.0	2.1	7.3	185
YE3-200L1-2	30	54.9	2965	93.3	0.89	2.0	2.3	7.6	241
YE3-200L2-2	37	67.4	2965	93.7	0.89	2.0	2.3	7.6	259
YE3-200L-4	30	56.6	1475	93.6	0.86	2.0	2.3	7.3	285
YE3-200L1-6	18.5	37.8	980	91.7	0.81	2.0	2.1	7.3	220
YE3-200L2-6	22	44.8	980	92.2	0.81	2.0	2.1	7.4	259
YE3-225M-2	45	80.8	2965	94.0	0.90	2.0	2.3	7.7	326
YE3-225S-4	37	69.6	1480	93.9	0.86	2.0	2.3	7.4	300
YE3-225M-4	45	84.4	1480	94.2	0.86	2.0	2.3	7.4	349
YE3-225M-6	30	59.1	985	92.9	0.83	2.0	2.1	6.9	285
YE3-250M-2	55	98.5	2970	94.3	0.90	2.0	2.3	7.7	415
YE3-250M-4	55	102.7	1480	94.6	0.86	2.2	2.3	7.4	434
YE3-250M-6	37	71.7	980	93.3	0.84	2.0	2.1	7.1	400

产品技术数据 SPECIFICATION

型号 Type	功率 Output (KW)	电流 Amps (A)	转速 Speed r/min	效率 Eff. (%)	功率因数 Power Factor	堵转转矩 额定转矩 Locked Rotor Torque Rated Torque	最大转矩 额定转矩 Breakdown Torque Rated Torque	堵转电流 额定电流 Locked Rotor Current Rated Current	重量 Weight (kg)
YE3-280S-2	75	133.7	2975	94.7	0.90	1.8	2.3	7.1	515
YE3-280M-2	90	159.9	2975	95.0	0.90	1.8	2.3	7.1	590
YE3-280S-4	75	136.3	1485	95.0	0.88	2.0	2.3	6.9	580
YE3-280M-4	90	163.2	1485	95.2	0.88	2.0	2.3	6.9	664
YE3-280S-6	45	85.8	985	93.7	0.85	2.0	2.0	7.3	483
YE3-280M-6	55	103.3	985	94.1	0.86	2.0	2.0	7.3	531
YE3-315S-2	110	195.1	2975	95.2	0.90	1.8	2.3	7.1	820
YE3-315M-2	132	233.6	2975	95.4	0.90	1.8	2.3	7.1	890
YE3-315L1-2	160	279.4	2975	95.6	0.91	1.8	2.3	7.2	980
YE3-315L2-2	200	348.6	2975	95.8	0.91	1.8	2.2	7.2	1060
YE3-315S-4	110	196.8	1480	95.4	0.89	2.0	2.2	7.0	875
YE3-315M-4	132	235.7	1480	95.6	0.89	2.0	2.2	7.0	980
YE3-315L1-4	160	285.1	1480	95.8	0.89	2.0	2.2	7.1	1070
YE3-315L2-4	200	351.7	1480	96.0	0.90	2.0	2.2	7.1	1160
YE3-315S-6	75	143.4	985	94.6	0.84	2.0	2.0	6.6	845
YE3-315M-6	90	169.5	985	94.9	0.85	2.0	2.0	6.7	910
YE3-315L1-6	110	206.8	985	95.1	0.85	2.0	2.0	6.7	1000
YE3-315L2-6	132	244.5	985	95.4	0.86	2.0	2.0	6.8	1120
YE3-355M-2	250	435.7	2980	95.8	0.91	1.6	2.2	7.2	1500
YE3-355L-2	315	549.0	2980	95.8	0.91	1.6	2.2	7.2	1700
YE3-355M-4	250	439.6	1490	96.0	0.90	2.0	2.2	6.9	1620
YE3-355L-4	315	553.9	1490	96.0	0.90	2.0	2.2	7.1	1780
YE3-355M1-6	160	295.7	990	95.6	0.86	1.8	2.0	6.8	1552
YE3-355M3-6	200	364.6	990	95.8	0.87	1.8	2.0	6.8	1660
YE3-355L-6	250	455.8	990	95.8	0.87	1.8	2.0	6.8	1810

产品技术数据 SPECIFICATION

型号 Type	功率 Out put (kW)	电流 Amps (A)	转速 Speed r/min	效率 Eff. (%)	功率因数 Power Factor Cos φ	堵转转矩 额定转矩 Locked Rotor Torque Rated Torque	堵转电流 额定电流 Locked Rotor Current Rated Current	最大转矩 额定转矩 Breakdown Torque Rated Torque	噪声 Noise LwdB(A)	重量 Weight kg
同步转速 750r/min										
YE3-90L-8	0.55	2.17	680	63.0	0.61	1.8	2.0	4.0	56	23
YE3-100L1-8	0.75	2.43	680	71.0	0.67	1.8	2.0	4.0	59	29
YE3-100L2-8	1.1	3.36	680	73.0	0.69	1.8	2.0	5.0	59	31
YE3-112M-8	1.5	4.40	690	75.0	0.70	1.8	2.0	5.0	61	41
YE3-132S-8	2.2	6.0	710	79	0.71	1.8	6.0	2.0	64	61
YE3-132M-8	3.0	7.8	710	80	0.73	1.8	6.0	2.0	64	74
YE3-160M1-8	4.0	10.3	720	81	0.73	1.9	6.0	2.0	68	950
YE3-160M2-8	5.5	13.6	720	83	0.74	1.9	6.0	2.0	68	107
YE3-160L-8	7.5	17.8	720	85.5	0.75	1.9	6	2	68	128
YE3-180L-8	11	25.5	730	87.5	0.75	2	6.5	2	70	169
YE3-200L-8	15	34.1	730	88	0.76	2	6.6	2	73	236
YE3-225S-8	18.5	41.1	730	90	0.76	1.9	6.6	2	73	274
YE3-225M-8	22	48.9	730	90.5	0.78	1.9	6.6	2	73	290
YE3-250M-8	30	63	735	91	0.79	1.9	6.5	2	75	370
YE3-280S-8	37	78	740	91.5	0.79	1.9	6.6	2	76	488
YE3-280M-8	45	94	740	92	0.79	1.9	6.6	2	76	563
YE3-315S-8	55	111	735	92.8	0.81	1.8	6.6	2	82	852
YE3-315M-8	75	150	735	93.5	0.81	1.8	6.6	2	82	933
YE3-315L1-8	90	178	735	93.8	0.82	1.8	6.6	2	82	1027
YE3-315L2-8	110	217	735	94	0.82	1.8	6.4	2	82	1117
YE3-355M1-8	132	261	740	93.7	0.82	1.8	6.4	2	90	2000
YE3-355M2-8	160	315	740	94.2	0.85	1.8	6.4	2	90	2150
YE3-355L-8	200	387	740	94.5	0.83	1.8	6.4	2	90	2250
YE3-355L-8	185	366A	740	94.5	0.83	1.8	6.4	2	90	2250
YE3-80M1-8	0.18	0.83	645	51.0	0.61	1.8	1.9	3.3	52	15
YE3-80M2-8	0.25	1.1	645	54.0	0.61	1.8	1.9	3.3	52	16
YE3-90S-8	0.37	1.49	675	62.0	0.61	1.8	1.9	4.0	56	20
同步转速 750r/min										
YE3-315S-10	45	100	590	91.5	0.75	1.5	6.2	2	82	818
YE3-315M-10	55	121	590	92	0.75	1.5	6.2	2	82	903
YE3-315L1-10	75	162	590	92.5	0.76	1.5	6.2	2	82	1007
YE3-315L2-10	90	191	590	93	0.77	1.5	6.2	2	82	1100
YE3-355M1-10	110	230	590	93.2	0.78	1.3	6	2	90	1800
YE3-355M2-10	132	275	590	93.5	0.78	1.3	6	2	90	2000
YE3-355L-10	160	334	590	93.5	0.78	1.3	6	2	90	2500

YE3外形及安装尺寸

YE3 SERIES CONTOUR AND INSTALLATION DIMENSIONS

IMB3

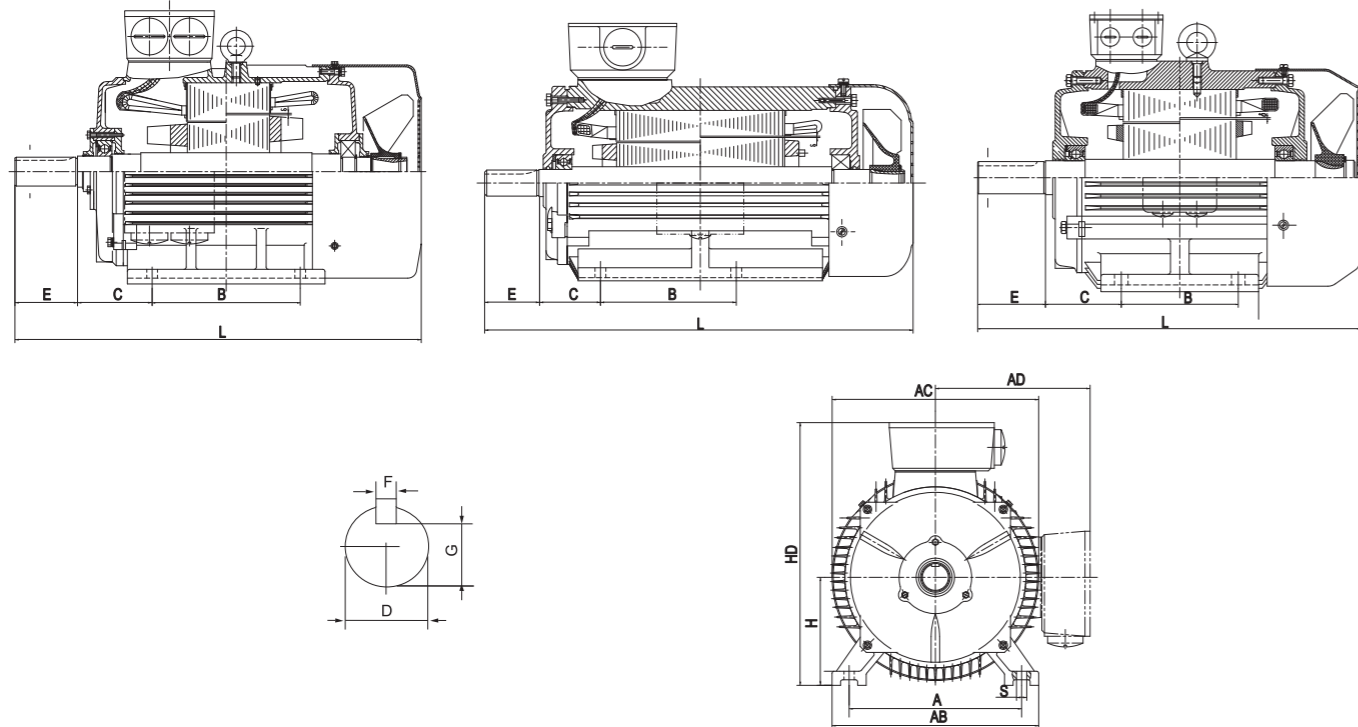

IMB35

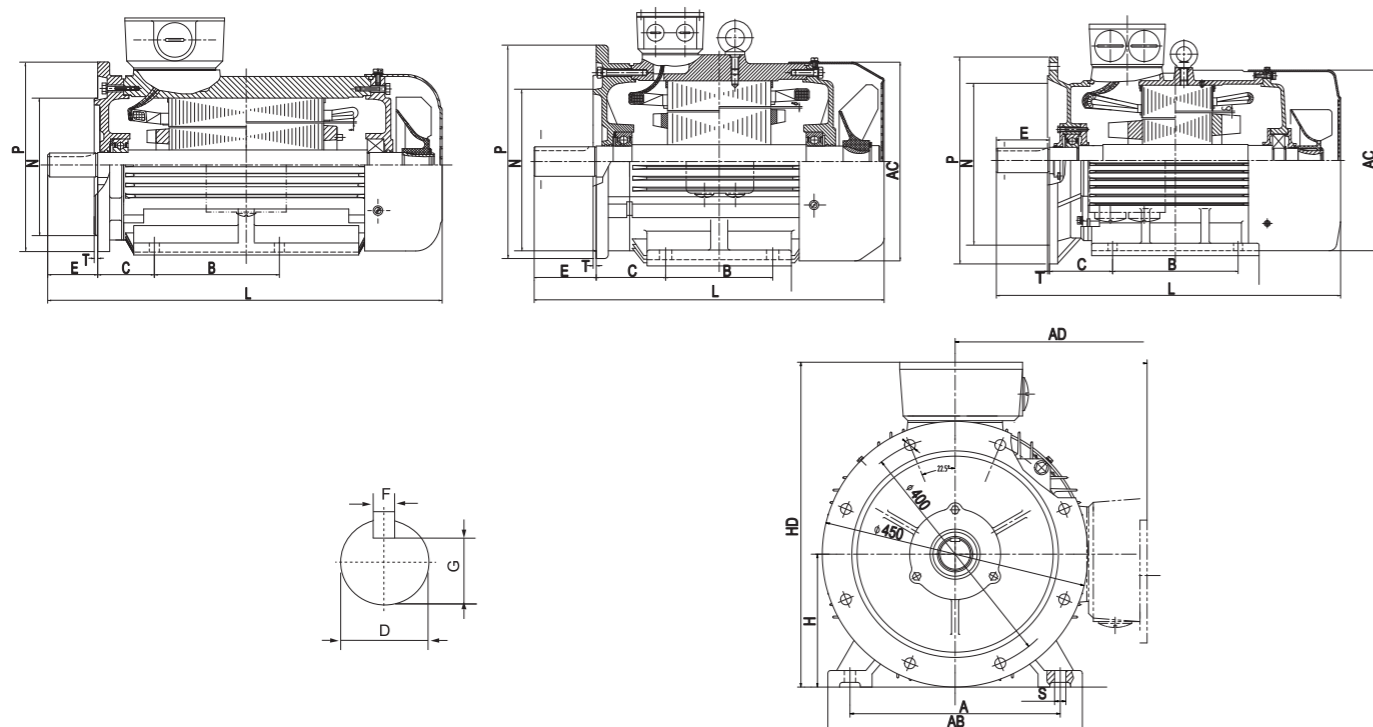

产品技术数据 SPECIFICATION

IMB3

机座号 Frame No.	极数 Poles	安装尺寸 Installation Dimensions									外形尺寸 External Dimensions				
		A	B	C	D	E	F	G	H	K	AB	AC	AD	HD	L
80M	2、4、6	125	100	50	19	40	6	15.5	80	10	165	175	145	220	305
90S		140		56	24	50	8	20	90		180	195	165	260	360
90L			125	63	28	60		24	100		205	215	180	275	400
100L		160	140				70			80	10	33	132	230	240
112M		190		210	108	42		110	12					37	160
132S		216	254				254			121	48	14	42.5		
132M		178		279	279	121		48	14					42.5	180
160M			254				318			305	133	55	16		
160L		279	318	305	133	55		16	49					200	18.5
180M							318			286	149	60	140		
180L	279	356	311	60	140	18	53	250	24					550	580
200L	318									406	349	168	140		
225S	4	457	368	190	75	20	67.5	280	24					550	580
225M	2									457	368	190	75		
250M	2	457	368	190	75	20	67.5	280	24					550	580
280S	2									406	457	216	65		
280M	4	508	457	216	65	140	18	58	280					635	645
315S	2									508	457	216	65		
315M	4	508	457	216	65	140	18	58	280					635	645
315L	2									610	560	254	75		
355M	4	610	560	254	75	140	20	67.5	355					730	710
355L	2									630	560	254	75		
	4	630	560	254	75	140	20	67.5	355					730	710

产品技术数据 SPECIFICATION

IMB35

机座号 Frame No.	凸缘号 Frame number	极数 Poles	安装尺寸 Installation Dimensions																	
			A	B	C	D	E	F	G	H	K	M	N	P	S	T	n			
80M	FF165	2, 4, 6	125	100	50	19	40	6	16	80	10	165	130	200	12	3.5	4			
90S			140		56	24	50	8	20	90										
90L			125	56	24	50														
100L	FF215		160	140	63	28	60	24	100	12	215	180	250	14.5	4					
112M			190		70	80	10									33		132		
132S	FF265		216	178	89	38	80	10	33							132		14.5	300	250
132M			216		89	38	80	10	33	132										
160M	FF300		2, 4, 6	254	210	108	42	110	12	37	160	14.5	300	250	350	14.5				
160L				254	108													42	110	12
180M				279	241	121	48	14	43	180										
180L				279	241						121	48	14	43	180					
200L	FF350			318	305	133	55	16	49	200	18.5	400	350	300	450	18.5		5		
225S	4	286		149	60	140	18	53	225											
225M	2	356			55	110	16	49												
250M	FF500	2, 4, 6		406	349	168	60	140	18	53	24	500	450	550	18.5	5				
																	2	60	140	18
				4, 6	65	140	18	58												
280S				FF500	2, 4, 6	457	368	190	65	140	20	68	280	500	450	550	18.5	5		
																			2	65
280M			2			419	190	65	140	18	58									
315S			FF600			2, 4, 6	508	406	216	65	170	22	71	315	28	600	550	660	24	6
							4, 6	80	170	22	71									
315M				FF600	2, 4, 6		508	457	216	65	140	18	58	315	28	600	550	660	24	6
315L							2	508	216	65	140	18	58							
355m	FF740	2, 4, 6	610			560	254	75	140	20	68	355	28	740	680	800	24	6		
																			4, 6	95
			355L			2	630	254	75	140	20								68	

注：IMB35外形尺寸AB、AC、AD、HD、L同IMB3

YE3系列

IMB5

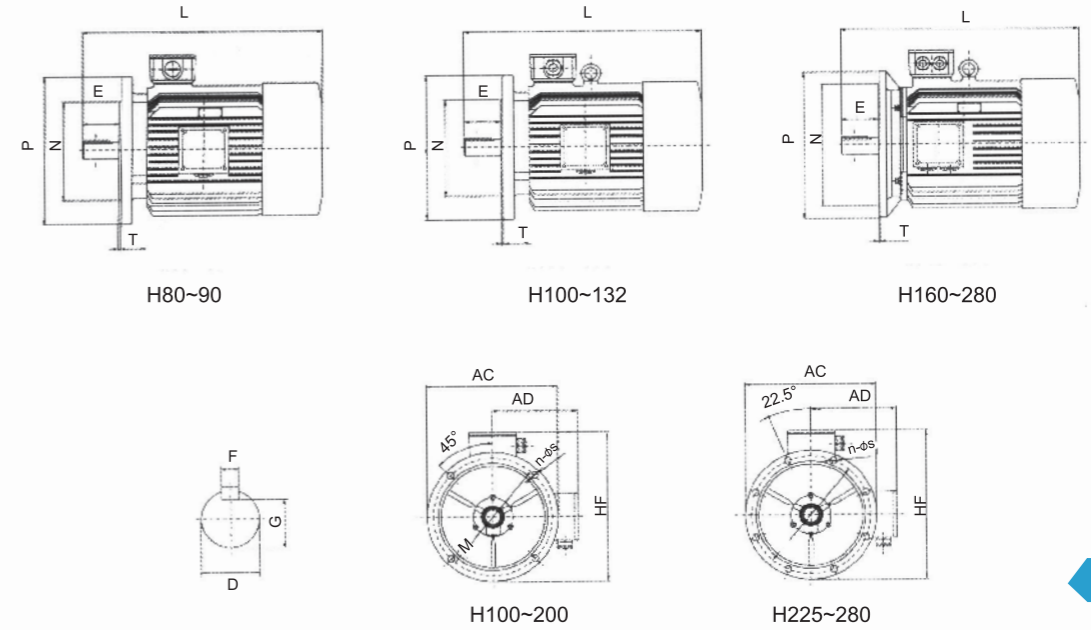

IMB5

机座号 Frame No.	凸缘号 Frame number	极数 Poles	安装尺寸 Installation Dimensions											外形尺寸 External Dimensions													
			D	E	F	G	M	N	P	S	T	n	AC	AD	HF	L											
80M	FF165	2, 4, 6	19	40	6	16	165	130	200	12	3.5	4	175	145	305												
90S			24	50	8	20										215	180	250	15	4	195	165	360				
90L			24	50	8	20										215	180	250	15	4	195	165	390				
100L	FF215		2, 4, 6	28	60	8	24	215	180	250	15		4	4	215	180	245	435									
112M				28	60	8	24	215	180	250									15	4	240	190	265	470			
132S	FF265			2, 4, 6	38	80	10	33	265	230					300	14.5	4	4	275	210	315	510					
132M					38	80	10	33	265	230	300		14.5		4								275	210	315	560	
160M	FF300				2, 4, 6	42	110	12	37	300	250		350		14.5				4	4	330	255	385	670			
160L						42		110	12							37	300								250	350	14.5
180M						48	110	14	43							300	250				350	14.5	4	380	280	430	740
180L						48	110	14	43	300	250		350		14.5	4	380		280		430	790					
200L	FF350					2, 4, 6	55	140	16	49	350		300		400	18.5	5		4		420	305	480	790			
225S	4	60					140		18	53	400	350	450		18.5										5	470	335
225M	2	55					110	16	49	400	350	450	18.5		5						470	335	535	825			
250M	FF500	2, 4, 6					610	560	254	75	140	20	68		24	6	4				510	370	595	915			
			4, 6											60											140	18	58
			2				65	140	18	58	510	370	595	915													
280S			FF500	2, 4, 6			610	560	254	75	140	20	68	24	6	4		580			410	650	1035				
																								4, 6	65	140	18
2					65		140	18	58	580	410	650	1035														
280M	FF500				2, 4, 6		610	560	254	75	140	20	68	24	6			4		580	410	650	1035				
																								4, 6	75	140	18
2							75	140	18	58	580	410	650							1035							

YE3系列

IMB14

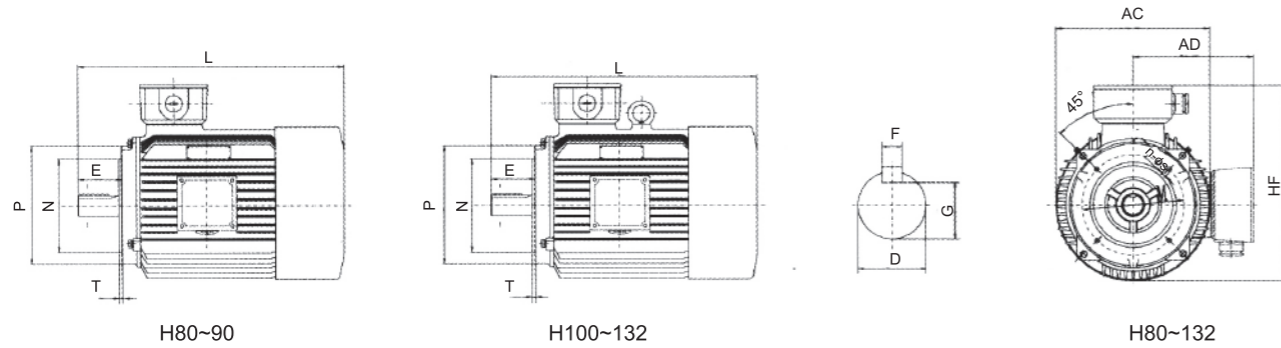

YE3系列

IMV1

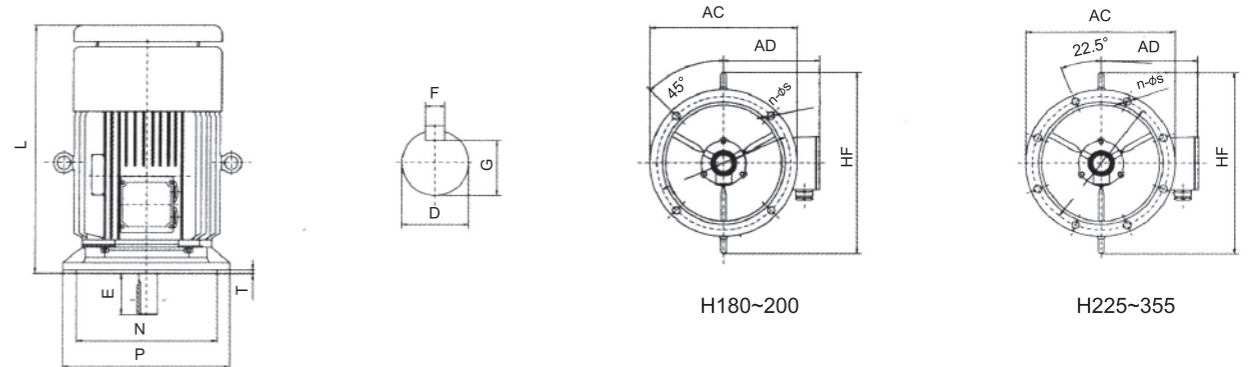

机座号 FrameNo.	凸缘号 Frame number	极数 Poles	安装尺寸 Installation Dimensions										外形尺寸 External Dimensions			
			D	E	F	G	M	N	P	S	T	n	AC	AD	HF	L
80M	FT100	2、4、6	19	40	6	15.5	100	80	120	M6	3.0	4	175	145		305
90S	FT115		24	50	8	20	115	95	140	M8			195	165		360
90L	FT130		28	60		24	130	110	160		3.5		215	180		245
100L					240	190	265	470								
112M																

IMB14

IMB34

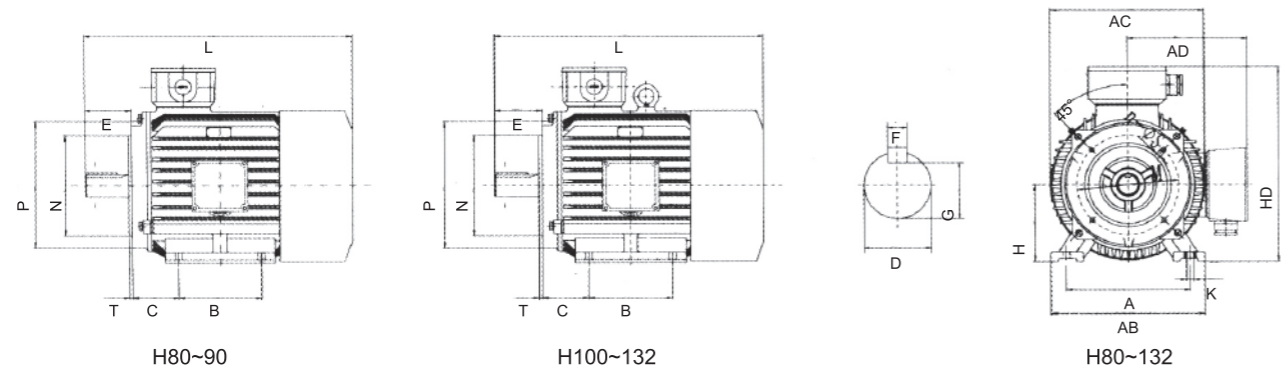

机座号 FrameNo.	凸缘号 Frame number	极数 Poles	安装尺寸 Installation Dimensions													外形尺寸 External Dimensions						
			A	B	C	D	E	F	G	H	K	M	N	P	S	T	n	AB	AC	AD	HD	L
80M	FT100	2、4、6	125	100	50	19	40	6	15.5	80	10	100	80	120	M6	3.0	4	165	175	145	220	305
90S	FT115		140		56	24	50	20	90	115		95	140	M8	180			195	165	260	360	
90L	FT130		140	125	8	24	60	24	100	12	130	110	160	3.5	205	215		180	275	435		
100L			190	70					112		230	240	190		300	470						
112M																						

IMB34

机座号 FrameNo.	凸缘号 Frame number	极数 Poles	安装尺寸 Installation Dimensions										外形尺寸 External Dimensions						
			D	E	F	G	M	N	P	S	T	n	AC	AD	HF	L			
180M	FF300	2、4、6	48	110	14	42.5	300	250	350	18.5	5	4	380	280	430	800			
180L			16		49	350	300	400	420				305	480	940				
200L	FF350		55																
225S	FF400	4	60	140	18	53	400	350	450	18.5	5	4				905			
225M		2	55	110	16	49							470	335	535	910			
		4、6	60			53										935			
250M	FF500	2	140	18	58	500	450	550	18.5	5	4	510	370	595	1015				
280S		4、6										75	20	67.5	580	410	650	1150	
		2										65	18	58				1385	
280M		4、6										75	20	67.5					
315S	FF600	2	65	140	18	58	600	550	660	24	6	4				1480			
315M		4、6	80	170	22	71							645	530	900	1510			
		2	65	140	18	58										1590			
315L		4、6	80	170	22	71										1620			
355M	FF740	2	75	140	20	67.5	740	680	800	24	6	4				1750			
355L		4、6	95	170	25	86							710	655	1010	1780			
		2	75	140	20	67.5										1750			
		4、6	95	170	25	86										1780			